



Resort Conference Guide

APPII

"The future of Japan. The future of Resort"

Appikogen, Hachimantai-city, Iwate 028-7396, JAPAN TEL: (81)195-73-6401 Fax: (81)195-73-5025 http://www.appi.co.jp/foreign_country/english/

Big Conference Rooms [APPI Plaza / APPI Resort Centre]

-Resort Conference Guide-

“Plaza Hall” has a seating capacity of maximum 1,600 people. The place is useful for conference, lecture, and exhibition for sale. It is also convenient to combine with “Makiba hall” for the various purposes. The both halls connect Hotel APPI Grand Main Building and Tower by a corridor.



Plaza Hall / Theater style



Makiba Hall



Plaza Hall / Buffet style

Plaza Hall

- Floor space / 1116㎡
- Height / 7.2m
- Seating capacity
 - Theater style / 1600
 - School style / 500
 - Party style (Round table) / 640
 - Party style (Stand-up) / 1000
- Equipment
 - PA & light control / Hanging pole

- Air conditioning
- Internet
- Others
 - Movable wall is available for division.
 - The floor space becomes 925㎡ for the use.
 - There are 5 kitchen facilities in the hall.

Makiba Hall

- Floor space / 482㎡
- Height 2.3m
- Seating capacity
 - Theater style / 400
 - School style / 200
 - Party style (Round table) / 200
 - Party style (Stand-up) / 250

- Air conditioning
- Internet
- Others
 - There are 2 kitchen facilities in the hall.

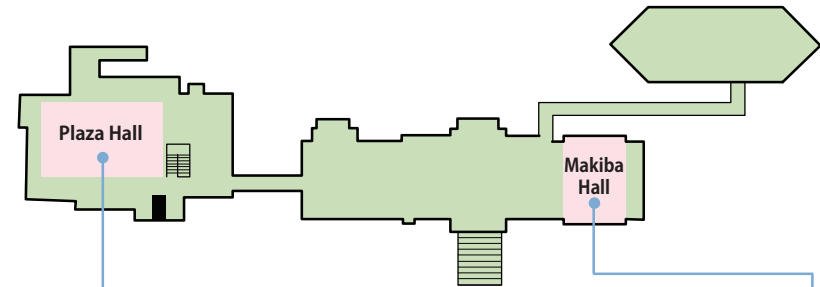

Plaza Hall / Ground Plan

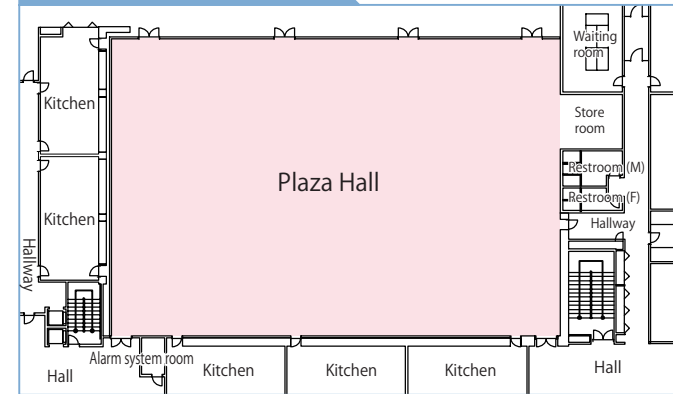

Makiba Hall / Ground Plan

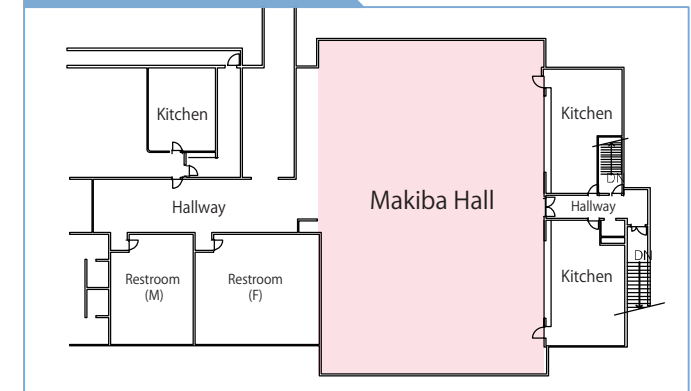

Big Conference Rooms [Hotel APPI Grand Main Building]

“Ryugamori” in Hotel APPI Grand has a seating capacity of maximum 500 people, and over 300 people can hold a stand-up party in this place. We have received the customer’s requests, such as the various academic meetings and incentive party. This place is very convenient after convention because the accommodation is very close.



Hotel APPI Grand / Ryugamori

Ryugamori / Ground Plan

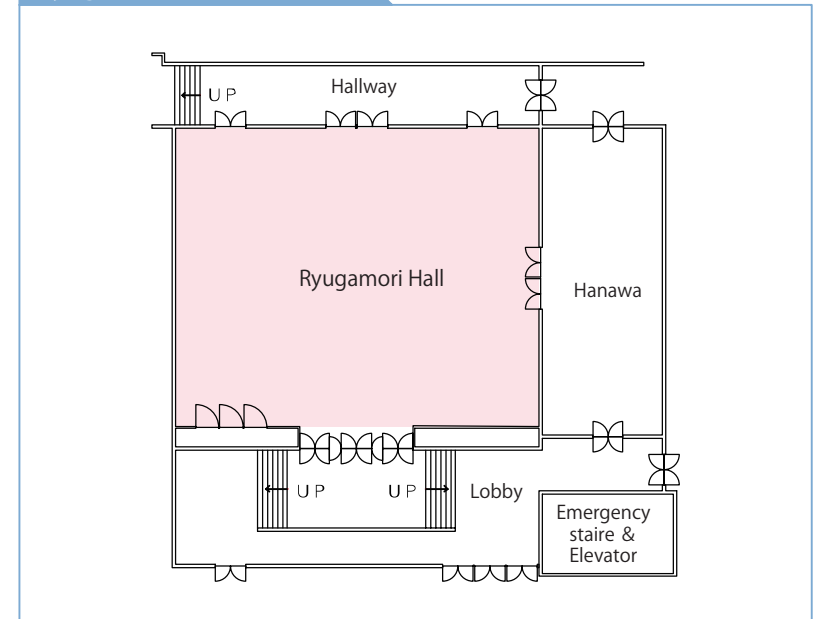

Ryugamori / Party style

Ryugamori Hall

- Floor space / 405㎡
- Height / 3m
- Seating capacity
 - Theater style / 500
 - School style / 300
 - Party style (Round table) / 264
 - Party style (Stand-up) / 300
- Equipment
 - PA & light control
 - Air conditioning
 - Internet

Examples

School style / 144 people

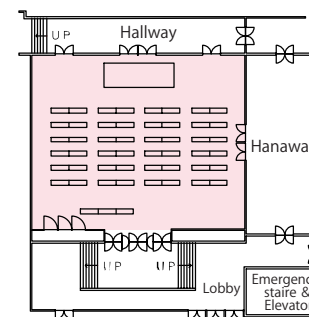

Party style / 140 people

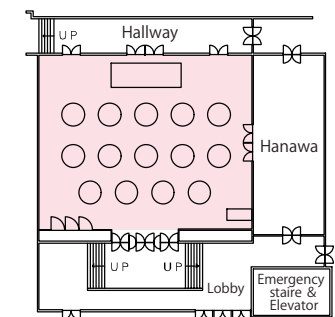

Conference Rooms [Hotel APPI Grand Main Building & Tower] *-Resort Conference Guide-* **APPI**

For conference or seminar, we have the various rooms for the sectional meeting or the break. It is also available for small group meeting or speakers as their waiting room.

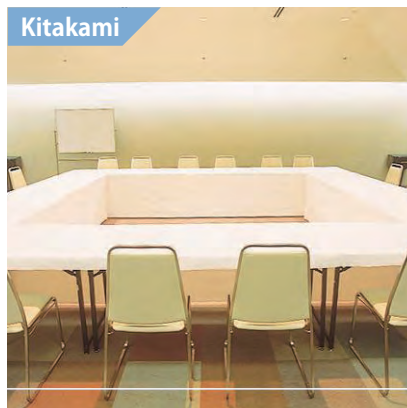
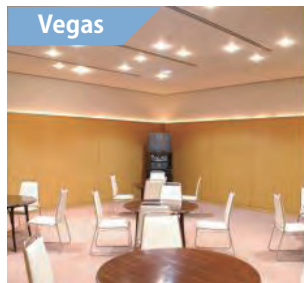

Main Building & Tower / Ground Plan

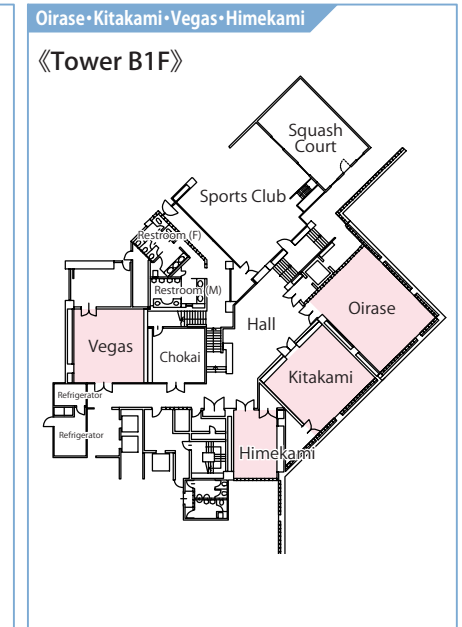
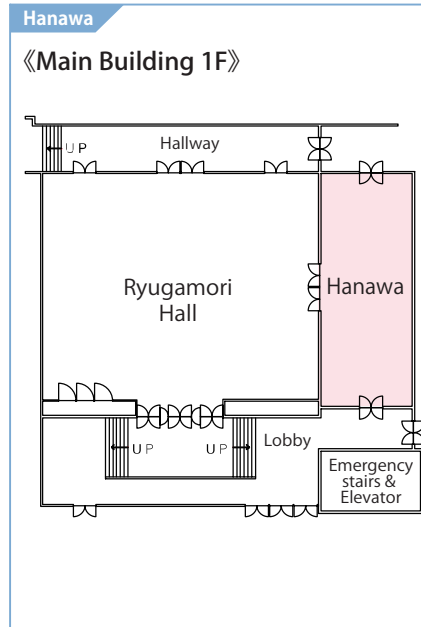

Hanawa

- Floor space / 126㎡
- Height / 3m
- Seating capacity
 Theater style / 100
 School style / 81
 Party style (Round table) / 60
 Party style (Stand-up) / 60
- Equipment / PA & light control
- Air conditioning
- Internet

Oirase

- Floor space / 80㎡
- Height / 3m
- Seating capacity
 Theater style / 80
 School style / 54
 Party style (Round table) / 60
 Party style (Stand-up) / 50
- Air conditioning
- Internet

Kitakami

- Floor space / 72㎡
- Height / 3m
- Seating capacity
 Theater style / 72
 School style / 48
 Party style (Round table) / 36
 Party style (Stand-up) / 40
- Air conditioning
- Internet

Vegas

- Floor space / 56㎡
- Height / 3m
- Seating capacity
 Theater style / 60
 School style / 36
 Party style (Round table) / 30
 Party style (Stand-up) / 30
- Air conditioning
- Internet

Himekami

- Floor space / 32㎡
- Height / 3m
- Seating capacity
 Theater style / 30
 School style / 24
 Party style (Stand-up) / 24
- Air conditioning
- Internet

Conference Rooms [APPI Grand Annex•Villa3]

-Resort Conference Guide-

There are “Yamaboshi”, which is a multipurpose room surrounded by white birch, and 2 other rooms in APPI Grand Annex adjoining APPI Onsen Patio. We also have “Green-point” space in APPI Grand Villa 3, which Japanese and Western style rooms are popular among schools. It is possible for everyone to use the various places in APPI resort for your achievement.

■APPI Grand Annex



Yamaboshi



Hayachine



Kurikoma

Yamaboshi

- Floor space / 432㎡
- Height / 3.8m
- Seating capacity
 - Theater style / 400
 - School style / 160
 - Party style (Round table) / 180
 - Party style (Stand-up) / 250
- Air conditioning
- Others
 - It can be divided into 2 spaces by movable walls; 180㎡ and 216㎡. Dining service is available at one space soon after conference at the other.

Hayachine

- Floor space / 88㎡
- Height / 2.5m
- Seating capacity
 - Theater style / 70
 - School style / 40
 - Party style (Round table) / 40
 - Party style (Stand-up) / 50
- Air conditioning

Kurikoma

- Floor space / 52㎡
- Height / 2.5m
- Seating capacity
 - Theater style / 40
 - School style / 30
- Air conditioning

■APPI Grand Villa 3



Green Point

Conference Rooms / Ground Plan

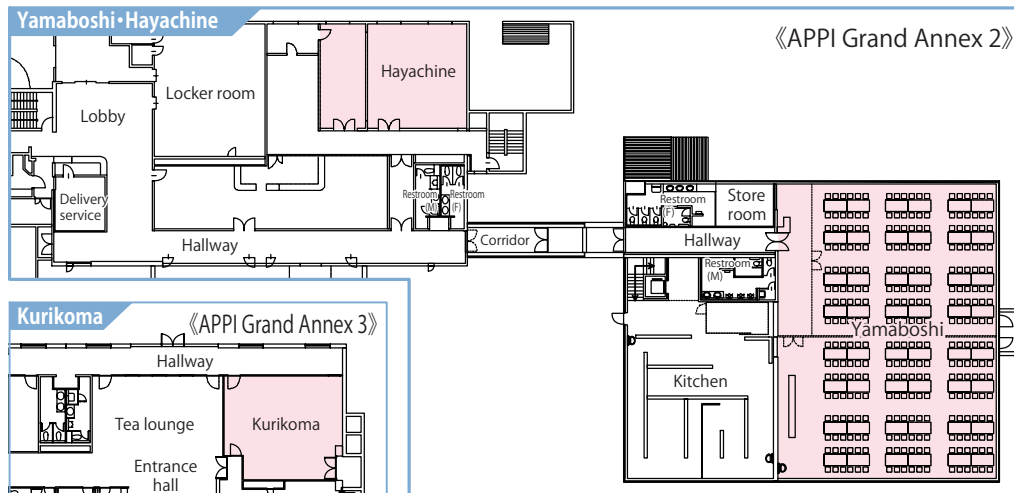

Green-Point / Ground Plan

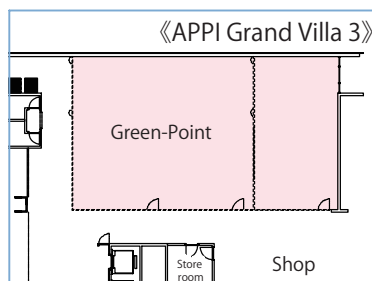

Green-Point

- Floor space / 210㎡
- Height / 3.1m
- Seating capacity
 - Theater style / 150
 - School style / 70
 - Party style (Round table) / 100
 - Party style (Stand-up) / 150
- Air conditioning
- Others
 - Summer season (May to November) only

Outdoor Event Space

Paved area and vast parking area are useful spaces in APPI resort. It is also available to hold big live concert or promotional event in front of ski slopes. Don't worry about parking area when you have a huge event outside.

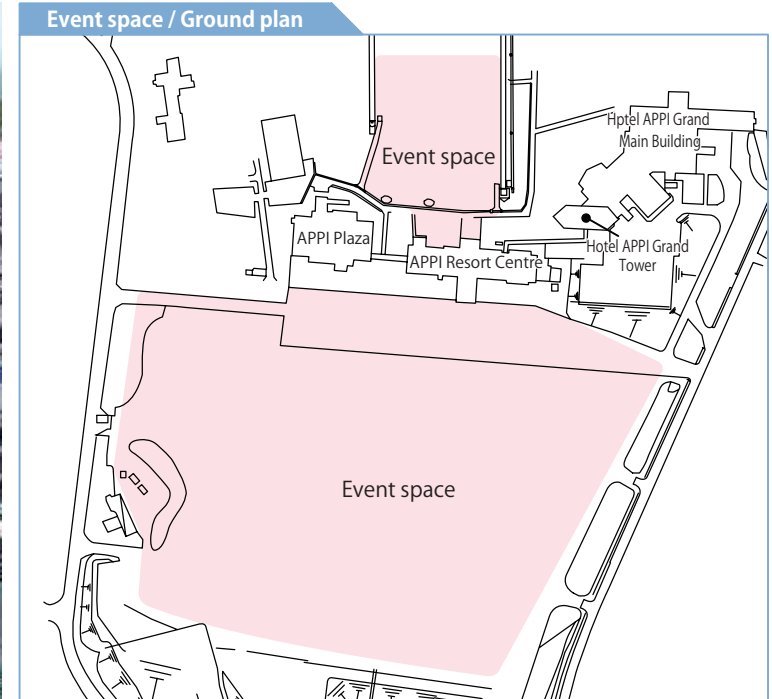

Social Gathering and Party [Layout / Long Table]

-Resort Conference Guide-

Party



This layout produces the big party or the event in a gorgeous style, and long tables create the space very elegant.



APPI Plaza

Long Tables for 510 people

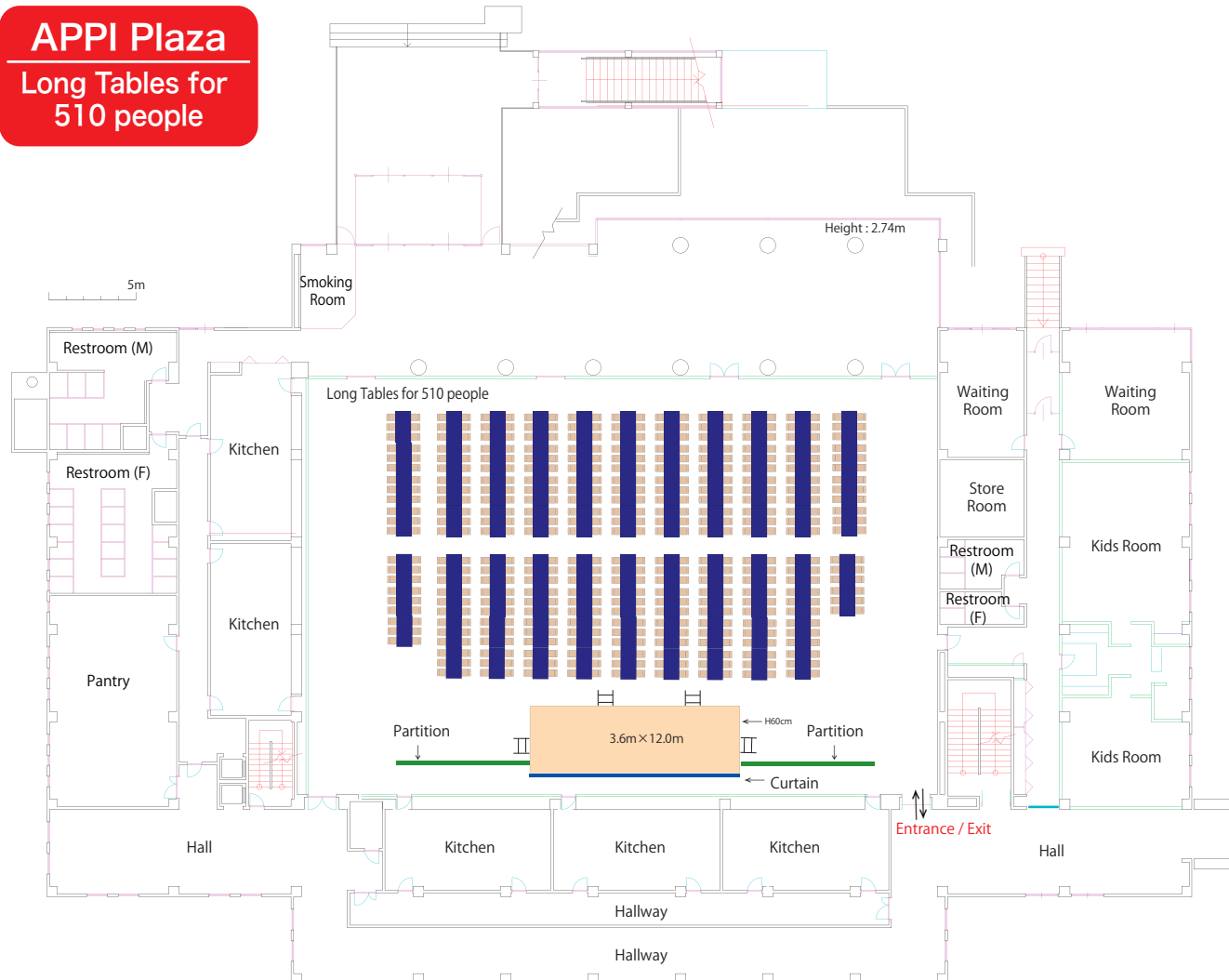

Model of Long Table's Layout



Social Gathering and Party [Layout / Round Table]

Party



This layout produces the big party or the event in a gorgeous style, and round tables create the space sociable and homely.



APPI Plaza
Round Tables for 500 people

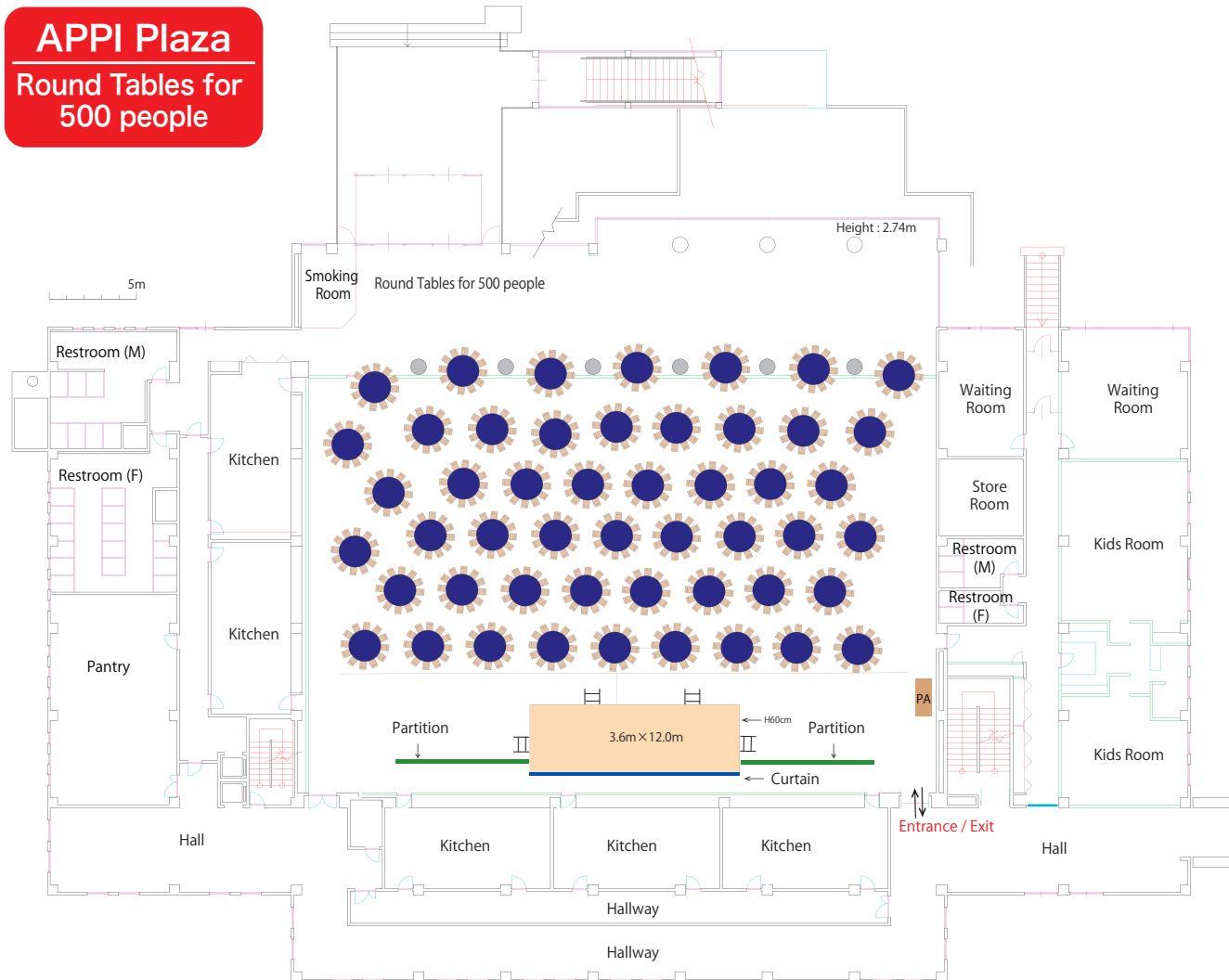

Model of Round Table's Layout



Whole Area Map [All Conference Room]

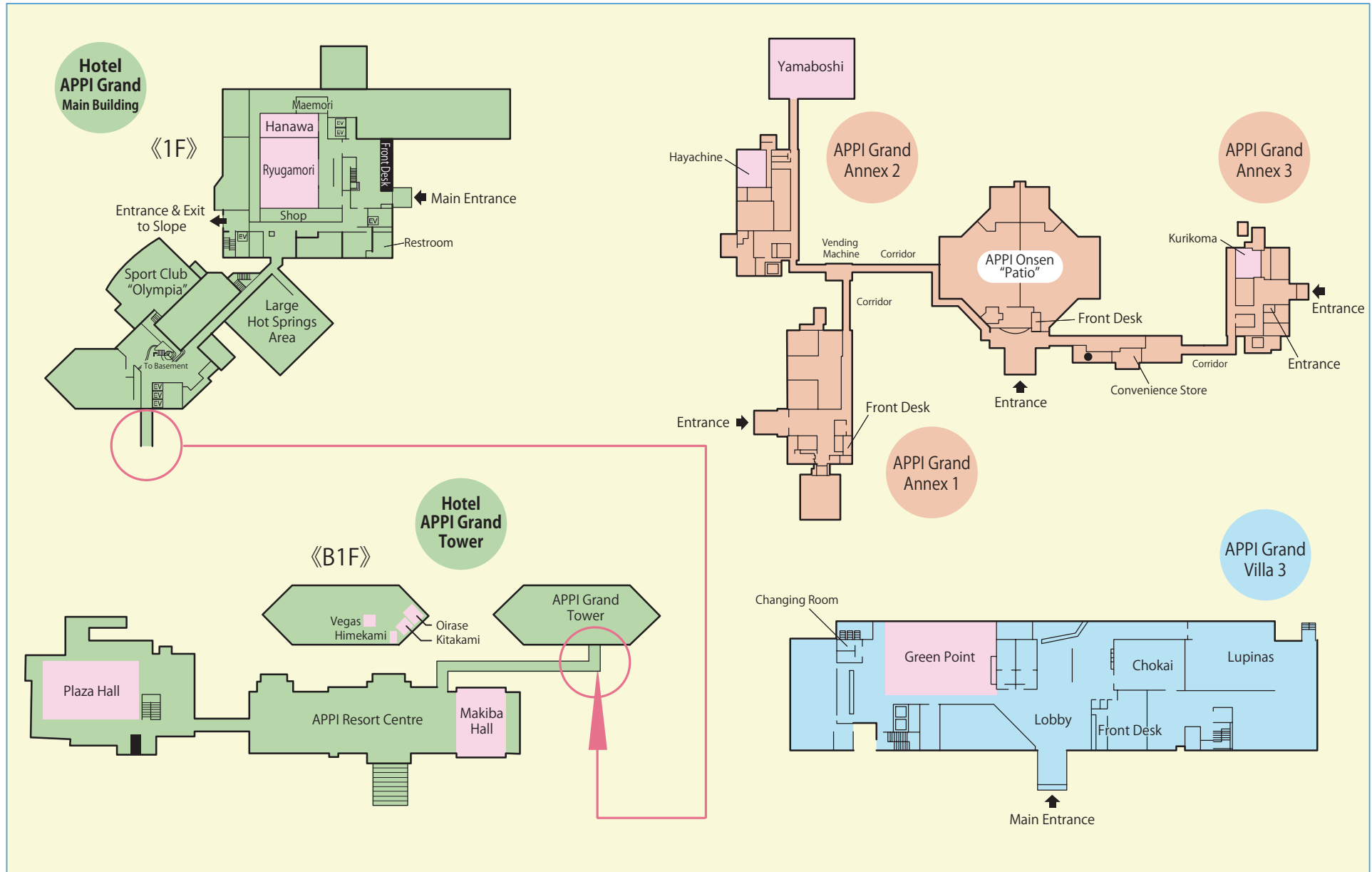

Information about Facilities [Content and Price List]

※If more than half of the assembly stay in APPI hotels, the following price will be discounted by 50 percent.

Facility	Place	Floor space & size		Theater persons	School persons	Stand-up persons	Round table persons	Square persons	2 hrs yen (w/ tax)	4 hrs yen (w/ tax)	1 day yen (w/ tax)	Extended 1 hr yen (w/ tax)	Note
		/m ²	L x W x H (m)										
Hotel APPI Grand	Ryugamori	405	18×22.5×3	500	300	300	264	—	126,000	189,000	378,000	63,000	
	Hanawa	126	18.5×6.8×3	100	81	60	60	36	42,000	63,000	126,000	21,000	
	Arlberg	172	26.5×6.5×2.7	150	100	150	130	—	42,000	63,000	—	21,000	For the use of the dais
	Maemori	36	9×4×3	30	24	—	20	—	10,500	15,750	31,500	5,250	
	Oirase	80	8×10×3	80	54	50	60	28	26,250	39,375	78,750	13,125	
	Kitakami	72	8×9×3	72	48	40	36	20	21,000	31,500	63,000	10,500	
	Vegas	56	7.6×7.4×3	60	36	30	30	16	16,800	25,200	50,400	8,400	
	Himekami	32	7×4.5×3	30	24	—	18	12	10,500	15,750	31,500	5,250	
	Chokai	29	5.6×5.2×3	24	18	—	12	12	10,500	15,750	31,500	5,250	
	Japanese Tea room (L)	32	7×4.45×2.4	18	—	—	—	—	23,100	—	—	—	The fee except for banquet
	Japanese Tea room (M)	9	3.6×2.6×2.4	6	—	—	—	—	5,775	—	—	—	
Japanese Tea room (S)	8	2.85×2.85×2	4	—	—	—	—	5,775	—	—	—		
APPI Grand Annex	(Whole Space)	432	18×24×3.8	400	160	250	180	—	105,000	157,500	315,000	52,500	Walls between hall A and B is movable.
	Yama boshi (Hall A)	180	15×12×3.8	200	50	100	80	—	52,500	78,750	157,500	26,250	
	(Hall B)	216	18×12×3.8	200	95	150	100	—	52,500	78,750	157,500	26,250	
	Hayachine	88	11×8×2.5	70	40	50	40	20	17,500	26,250	52,500	8,750	
Kurikoma	52	5.75×9×2.5	40	30	—	—	12	10,500	15,750	31,500	5,250		
APPI Grand Villa 3	Green-point	210	11.8×17.8×3.1	150	70	150	100	—	52,500	78,750	157,500	26,250	Summer only
APPI Plaza	Plaza (Full Open)	1,116	36×31×7.2	1,600	500	1,000	640	—	231,000	346,500	693,000	115,500	
	Hall (Space w/ Division)	925	25×37×6.3	1,200	405	800	480	—	—	—	—	—	
	Sakura	49	7×7×2.74	40	33	—	—	—	10,500	15,750	31,500	5,250	
	Donguri	32	7×4.5×2.74	30	9	—	—	—	5,250	7,875	15,750	2,625	
APPI Resort Centre	Makiba Hall	486	18×27×2.3	400	200	250	200	—	145,800	218,700	437,400	8,665	
Others	Parking Area	Capacity: 7,000 cars max.							—	115,500	207,900	—	
	Shirakaba Run	Capacity: 37,000 people max.							—	115,500	207,900	—	
	Lights for Night	Price for one lift's light							57,750	92,400	—	—	

Reference

- Stage size (L x W x H).....240×120×40(cm)
- Meeting's table size (L x W).....75×150(cm)
- Party's table size (L x W).....45×180(cm)
- Party's round table size.....Diameter 200(cm)

Information about Facilities [Hireable List]

Item / Employee	Size: L x W (cm)	Price (w/ Tax)	Unit	Number of Stock	Note	Item / Employee	Size: L x W (cm)	Price (w/ Tax)	Unit	Number of Stock	Note
Slide Screen (Portable)	180×180	5,250	1 day	2		Constructing Internet Space		Depending on numbers of line or term of use			
White Board		5,250	1 day	6		Security for Car Parking		1 night 29,400	1 person		Additional charge for meal
Cabin Projector		21,000	1 day	2		Group Photo	w/o Mount	1,050	1 sheet		
Liquid Crystal Projector		31,500	1 day	2			w/ Mount	1,260	1 sheet		
Screen for Liquid Crystal Projector		10,500	1 day	1		Filming	90 minutes	84,000	1 roll		
Laser Pointers		3,100	1 day	2		Snap Photos	w/ Negative	52,500	Approx. 70 pictures		
Video(VHS)	Monitor	5,250	1 day	1		Sake Barrel		34,650	Approx. 72 liter		
	Player	5,250	1 day	2		Name Label		From 84	1 sheet		
DVD		5,250	1 day	1		Invitation	Name only	157	1 sheet		
Set of OHP and Screen		10,500	1 day	2			Address	160	1 sheet		
Signboards	Hanging	60×500 (Size of Ryugamori)	26,250	1 item	Additional charge for logotype design		Title	170	1 sheet		
		90×900 (Size of Plaza)	52,500	1 item		Guest Book		2,500	1 item		
	Standing	240×85	21,000	1 item		MC		6,000	1 person		
Program for Ceremony	60×200	About 5,250~21,000			Additional charge for numbers of words	Table Flower		3,500	1 item		
Banner	For Stage	200×53 (Size of Ryugamori)	12,600			Flower w/ Vase		20,000	1 item		
	For Table	21×34	1,260			Stand Styled Flower		20,000	1 item		
Bingo Game		10,500			Additional charge for prize	Flower in Low Container		10,000	1 item		Depending on size of meal table
Karaoke		5,250	2 hrs		Self-service	Flower for Meal's Table		About 30,000~50,000			
		2,000	Extended 1 hr			Table Cover		3,000	1 item		
Hostess	Per person		15,750	2 hrs	Western dress only	Table Long Mat		2,000	1 item		
			3,938	Additional 30 min		Table Cover + Long Mat		4,500	1 item		
PA & Light		Depending on the scale				Chair Cover		500	1 item		
PA, Light, & Filming						Balloon Decoration		From 50,000	Need to Contact		
PA		From 52,000				Piano		25,000	1 item		
Instruments		Drum / Amplifier: From 5,250 for each									